

PREPARED BY:
JOHN L. BISCHOF, ESQUIRE
c/o Post Office Box 3621
Tallahassee, FL 32315

RE: NATURAL WELLS HOMEOWNER ASSOCIATION, INC

NOTICE OF PRESERVATION OF COVENANTS AND RESTRICTIONS
UNDER MARKETABLE RECORD TITLE AC

The Notice of Preservation of Covenants and Restrictions under the Marketable Record Title Act is dated July 6, 2017 and has been approved by the Natural Wells Homeowners Association Inc., (the "Association"). This Notice preserves the covenants, conditions and restrictions of the Declaration of Covenants, Conditions and Restrictions for Natural Wells Homeowners Association, Inc.

The Board of Directors has taken action to ensure that the Declaration of Covenants, Conditions and Restrictions, recorded in Official Records as follows:

June 8 1984 - Book 1117, Page 1261
February 25, 1986 - Book 1196, Page 1351
February 10, 1987 - Book 1247, Page 0930;
March 14, 1990 - Book 1423, Page 0491
January 31, 1992 - Book 1541, Page 0388
November 14, 1995 - Book 1856, Page 2204

of the public records of Leon County, Florida, as may be amended from time to time, currently burdening the property of each and every member of the Association, retains its status as the source of marketable title with regard to the transfer of a member's residence.

To this end, the Association shall cause this notice required by Chapter 712, Florida Statutes, to be recorded in the public records of Leon County, Florida. Copies of this notice and its attachments are available through the Association pursuant to the Association's governing documents regarding official records of the Association.

By reference the original covenants recorded in Official Records as listed above of the public records of Leon County, Florida are incorporated to this Notice.

This Notice affects all lots and other land identified in the legal descriptions and drawings by Exhibit A, B, and C attached. These documents were originally recorded with the Declaration of Covenants, Conditions and Restrictions as listed above of the public records of Leon County Florida. In addition, Exhibits D and E further describe the Natural Wells Subdivision.

This Notice shall have the effect of preserving the Declaration of Covenants, Conditions and Restrictions.

The Association gave all members of the Association at least a seven-days notice before the Board of Directors meeting to consider approving the filing of this Notice. The Notice to the members included the Statement of Marketable Title Action substantially in the form continued in Section 712.06(b), Florida Statutes. The affidavit is attached as Exhibit F to this Notice affirms the Board of Directors complied with this requirement.

The Association executed this Notice in the presence of the witnesses indicated below.

IN WITNESS WHEREOF, the undersigned being an elected officer of the Natural Wells Homeowner Association, has hereunto set its hand and seal this 6th day of July, 2017.



[Signature]
Witness:
[Signature]
Witness:

[Signature]
Hector DeLaO, President
Natural Wells Homeowner Association, Inc.
Post Office Box 3621
Tallahassee, FL 32315

STATE OF FLORIDA
COUNTY OF LEON

The foregoing Statement of Marketable Title Action was acknowledged before me this 6TH
day of July, 2017 by Hector DeLaO. She is personally known to me or produced _____ as
identification.

[Signature]
Notary
Commission Expires:

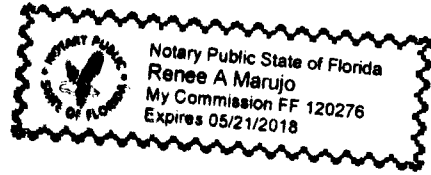

I do not claim any interest in the property listed in the security agreement. However, my guarantee of payment of the note total includes any amounts agreed to be paid under the terms of the security agreement.

LEGAL DESCRIPTION OF NATURAL WELLS
SUB-DIVISION

PARCEL 1 -

Commence at the Northeast corner of the Northwest Quarter of the Southwest Quarter of Section 21, Township 2 South, Range 1 East, Leon County, Florida, and thence run East 267.27 feet to the POINT OF BEGINNING. From said POINT OF BEGINNING run North 00 degrees 06 minutes 18 seconds East 260.77 feet to the Southerly boundary of a 60.00 foot roadway easement, thence run East along said Southerly boundary 704.12 feet to the centerline of the 100.00 foot right-of-way of a City of Tallahassee power line easement, thence run South 11 degrees 36 minutes 17 seconds East along said centerline 266.20 feet, thence run West 758.14 feet to the POINT OF BEGINNING; containing 4.38 acres, more or less.

Subject to a City of Tallahassee power line easement over and across the East 50.00 feet thereof.

ALSO:

OR111701272

PARCEL 2 -

Commence at the Northeast corner of the Northwest Quarter of the Southwest Quarter of Section 21, Township 2 South, Range 1 East, Leon County, Florida, and thence run North 00 degrees 06 minutes 18 seconds East 320.77 feet to the POINT OF BEGINNING. From said POINT OF BEGINNING run North 00 degrees 12 minutes 40 seconds East 2337.49 feet to the Northwest corner of the Northeast Quarter of the Northwest Quarter of said Section 21, thence run South 89 degrees 53 minutes 36 seconds East 470.51 feet to the centerline of the 100.00 foot right-of-way of a City of Tallahassee power line easement, thence run South 11 degrees 36 minutes 17 seconds East along said centerline 2385.36 feet to the Northerly boundary of a 60.00 foot roadway easement, thence run West along said Northerly boundary 958.96 feet to the POINT OF BEGINNING; containing 38.34 acres, more or less.

Subject to a City of Tallahassee power line easement over and across the East 50.00 feet thereof.

LESS AND EXCEPT:

Lot 5 - Commence at the Northeast corner of the Northwest Quarter of the Southwest Quarter of Section 21, Township 2 South, Range 1 East, Leon County, Florida, thence run North 00 degrees 06 minutes 18 seconds East 320.77 feet to the Northerly boundary of a 60.00 foot roadway, thence run North 00 degrees 12 minutes 40 seconds East 450.00 feet for the POINT OF BEGINNING. From said POINT OF BEGINNING continue North 00 degrees 12 minutes 40 seconds East 125.00 feet, thence run East 372.67 feet to the point on the center line of a 60.00 foot roadway, said point being on a curve concave to the Easterly, thence run Southerly along said center line and along said curve with a radius of 287.70 feet, through a central angle of 12 degrees 01 minutes 36 seconds for an arc distance of 60.39 feet, thence run South 15 degrees 14 minutes 14 seconds East along said center line 67.89 feet, thence leaving said center line run West 400.64 feet to the POINT OF BEGINNING; containing 1.10 acres, more or less.

Subject to a roadway easement over and across the East 30.00 feet thereof.

ALSO LESS AND EXCEPT:

Lot 6 - Commence at the Northeast corner of the Northwest Quarter of the Southwest Quarter of Section 21, Township 2 South, Range 1 East, Leon County, Florida, thence run North 00 degrees 06 minutes 18 seconds East 320.77 feet to the Northerly boundary of a 60.00 foot roadway, thence run North 00 degrees 12 minutes 40 seconds East 575.00 feet for the POINT OF BEGINNING. From said POINT OF

EXHIBIT "A"
Page 1 of 4 Pages



UNOFFICIAL DOCUMENT

BEGINNING continue North 00 degrees 12 minutes 40 seconds East 125.00 feet, thence run East 392.81 feet to the center line of a 60.00 foot roadway, thence run South 19 degrees 30 minutes 16 seconds West 13.61 feet to a point of curve to the left, thence run along said center line and along said curve with a radius of 287.70 feet, through a central angle of 22 degrees 42 minutes 54 seconds for an arc distance of 114.06 feet, thence leaving said center line run West 372.67 feet to the POINT OF BEGINNING; containing 1.09 acres, more or less.

Subject to a roadway easement over and across the East 30.00 feet thereof.

OR1117PC1273

ALSO LESS AND EXCEPT:

Lot 27 - Commence at the Northeast corner of the Northwest Quarter of the Southwest Quarter of Section 21, Township 2 South, Range 1 East, Leon County, Florida, and thence run East 1025.15 feet to the centerline of the 100.00 foot right-of-way of a City of Tallahassee power line easement, thence run North 10 degrees 59 minutes 36 seconds West along said centerline 877.71 feet to the POINT OF BEGINNING. From said POINT OF BEGINNING thence run North 85 degrees 57 minutes 40 seconds West 483.59 feet to a point on a curve on the centerline of a 60 foot roadway easement, said curve being concave to the Southeasterly, thence run Northerly along said centerline and along said curve with a radius of 287.70 feet, through a central angle of 22 degrees 42 minutes 54 seconds for an arc distance of 114.06 feet, thence run North 19 degrees 30 minutes 16 seconds East along said centerline 13.61 feet, thence leaving said centerline run East 430.78 feet to the centerline of said power line easement, thence run South 10 degrees 59 minutes 36 seconds East 162.04 feet to the POINT OF BEGINNING; containing 1.50 acres, more or less.

Subject to a roadway easement over and across the Westerly 30.00 feet thereof.

Subject to a power line easement over and across the Easterly 50.00 feet thereof.

ALSO LESS AND EXCEPT:

Lot 35 - Commence at the Northeast corner of the Northwest Quarter of the Southwest Quarter of Section 21, Township 2 South, Range 1 East, Leon County, Florida, and thence run East 449.35 feet to the POINT OF BEGINNING. From said POINT OF BEGINNING run North 00 degrees 06 minutes 18 seconds East 290.76 feet, thence run East 182.08 feet, thence run South 00 degrees 06 minutes 18 seconds West 290.76 feet, thence run West 182.08 feet to the POINT OF BEGINNING; CONTAINING 1.22 acres, more or less.

Subject to a roadway easement over and across the Northerly 30.00 feet thereof.

ALSO LESS AND EXCEPT:

Lot 36 - Commence at the Northeast corner of the Northwest Quarter of the Southwest Quarter of Section 21, Township 2 South, Range 1 East, Leon County, Florida, and thence run East 267.27 feet to the POINT OF BEGINNING. From said POINT OF BEGINNING run North 00 degrees 06 minutes 18 seconds East 260.77 feet, thence run North 40 degrees 35 minutes 02 seconds West 45.35 feet, thence run East 216.14 feet, thence run South 00 degrees 06 minutes 18 seconds West 290.76 feet, thence run West 182.08 feet to the POINT OF BEGINNING; containing 1.22 acres, more or less.

Subject to a roadway easement over and across the Northerly 30.00 feet thereof.

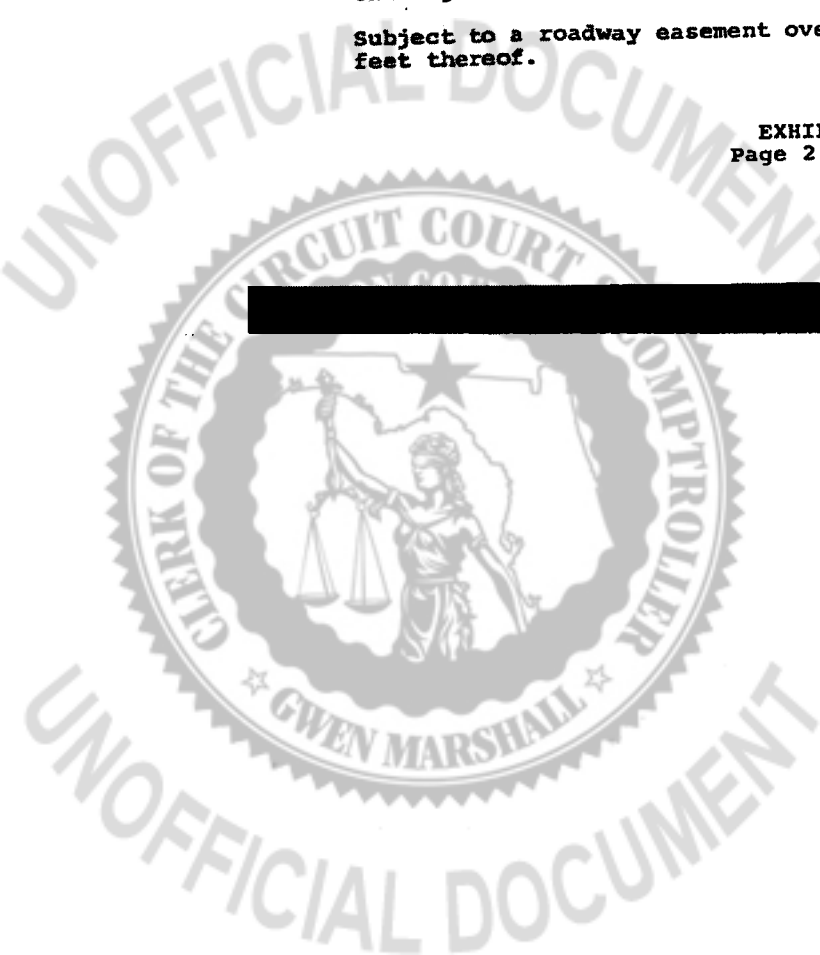

OR1117PC1274

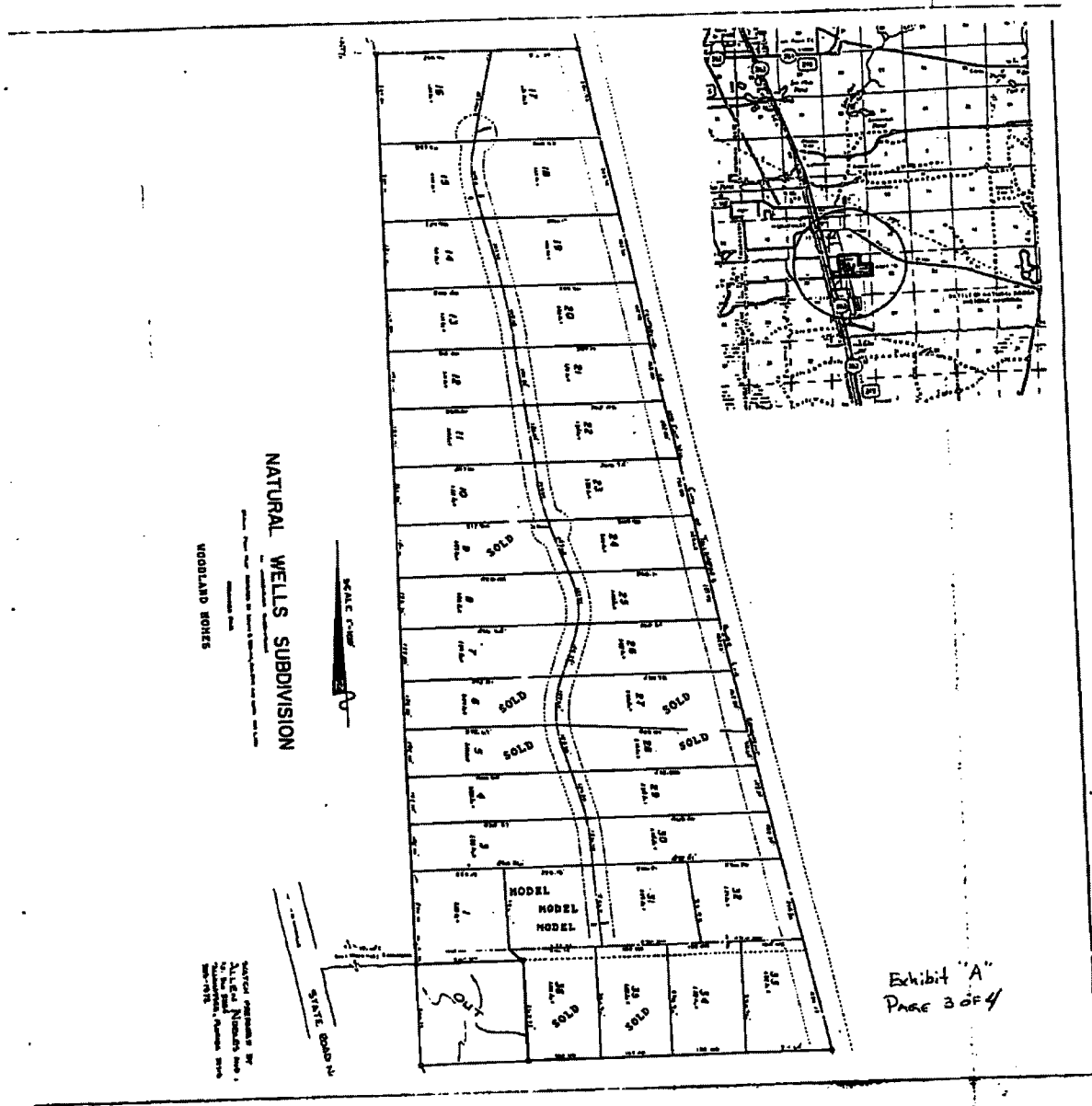

Exhibit "A"
Page 3 of 4

UNOFFICIAL DOCUMENT



UNOFFICIAL DOCUMENT

OR1117PC1275

ALSO:

Begin at the Northwest corner of the Northeast Quarter of the Southwest Quarter of Section 21, Township 2 South, Range 1 East, Leon County, Florida, and run thence North 00 degrees 06 minutes 18 seconds East 260.77 feet to the Point of Beginning. From said Point of Beginning continue North 00 degrees 06 minutes 18 seconds East 60 feet, thence run North 89 degrees 50 minutes 47 seconds West 1160.21 feet to a point on the Easterly right of way boundary of State Road No. 363, thence run South 10 degrees 15 minutes 24 seconds East along said right of way 61 feet thence leaving said Right of Way run south 89 degrees 50 minutes 47 seconds East 1149.24 feet to the Point of Beginning, containing 1.59 acres, more or less.

EXHIBIT "A"

Page 4 of 4 Pages

UNOFFICIAL DOCUMENT



UNOFFICIAL DOCUMENT

A 60 foot roadway easement, lying 30 feet each side of the following centerline: **DR1117PG1276**

Commence at a found concrete monument marking the Southwest corner of the Southeast Quarter of the Northwest Quarter of Section 21, Township 2 South, Range 1 East, Leon County, Florida and thence run North 00 degree 06 minutes 18 seconds East a distance of 260.77 feet to an iron pipe, thence continue North 00 degrees 06 minutes 18 seconds East 30.00 feet to the POINT OF BEGINNING of the centerline to be described herein. From said POINT OF BEGINNING run East along said centerline 968.14 feet to the centerline of a 100 foot power line easement to the City of Tallahassee and the end of said centerline.

ALSO: A 60 foot roadway easement, lying 30 feet each side of the following centerline:

Commence at a found concrete monument marking the Southwest corner of the Southeast Quarter of the

Northwest Quarter of Section 21, Township 2 South, Range 1 East, Leon County, Florida and thence run North 00 degree 06 minutes 18 seconds East a distance of 260.77 feet to an iron pipe, thence continue North 00 degrees 06 minutes 18 seconds East 30.00 feet to the centerline of a 60 foot roadway easement, thence run East along said centerline 466.42 feet to the POINT OF BEGINNING of the centerline to be described herein. From said POINT OF BEGINNING run along said centerline North 03 degrees 49 minutes 20 seconds West 285.07 feet to a point of curve to the left having a radius of 600.33 feet and a central angle of 11 degrees 24 minutes 54 seconds, thence run along said curve 119.60 feet (chord North 09 degrees 31 minutes 47 seconds West 119.39 feet), thence run North 15 degrees 14 minutes 14 seconds West 169.21 feet to a point of curve to the right having a radius of 287.70 feet and a central angle of 34 degrees 44 minutes 30 seconds, thence run along said curve 174.45 feet (chord North 02 degrees 08 minutes 01 seconds East 171.79 feet), thence run North 19 degrees 30 minutes 16 seconds East 116.80 feet to a point of curve to the left having a radius of 230.99 feet and a central angle of 38 degrees 12 minutes 18 seconds, thence run along said curve 154.03 feet (chord North 00 degrees 24 minutes 07 seconds East 151.19 feet), thence run North 18 degrees 42 minutes 02 seconds West 150.06 feet to a center of a 50 foot cul-de-sac, thence run Northwesterly along a centerline curve to the right having a radius of 540.59 feet for an arc distance of 119.51 (chord North 12 degrees 22 minutes 02 seconds West 119.27 feet), thence run North 06 degrees 02 minutes 02 seconds West 375.89 feet to a point of curve to the left having a radius of 1176.96 feet, thence run along said curve 119.90 feet (chord North 08 degrees 57 minutes 08 seconds West 119.84 feet), thence run North 11 degrees 52 minutes 14 seconds West 286.05 feet to a point of curve to the right having a radius of 233.03 feet, thence run along said curve 98.51 feet (chord North 00 degrees 14 minutes 22 seconds East 97.77 feet), thence run North 12 degrees 20 minutes 58 seconds East 50.00 feet to the center of a 50 foot radius cul-de-sac and the end of said centerline.

ALSO:

EXHIBIT "B" COMMON AREA

PAGE 1 of 3

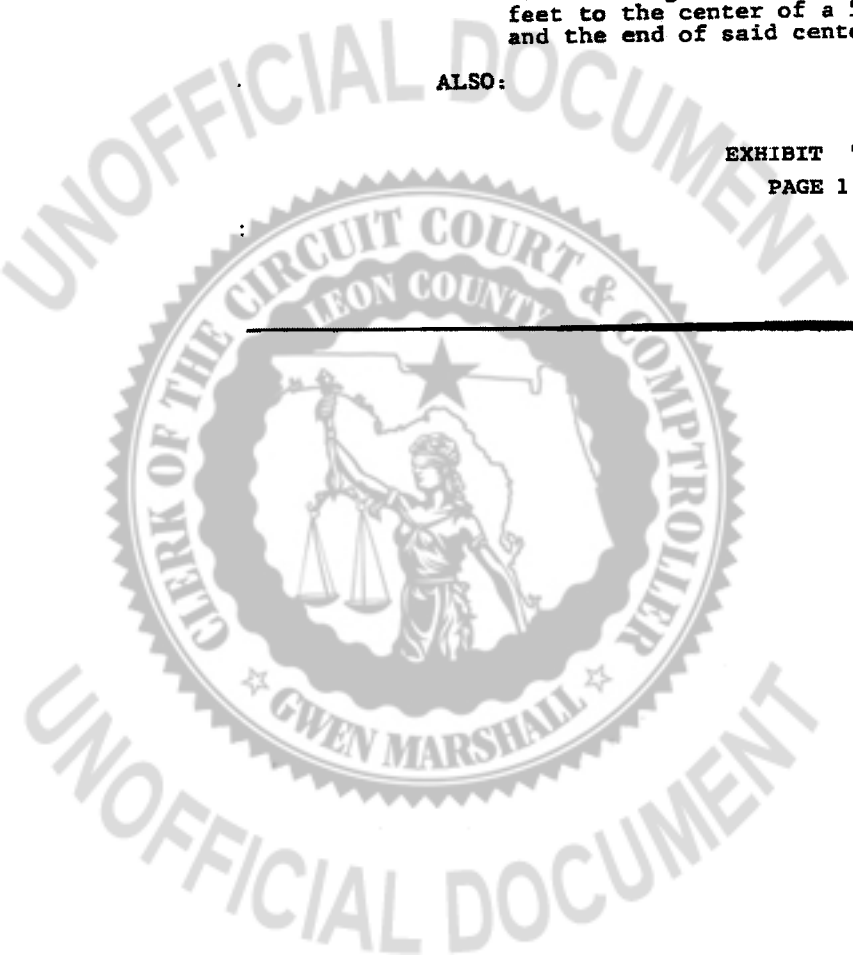

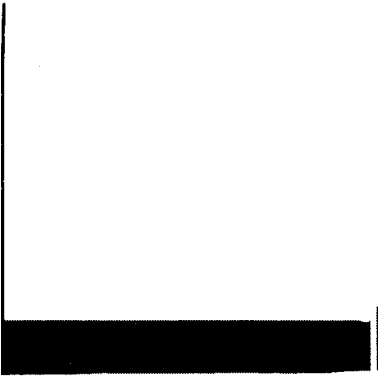

OR1117PG1277

ALSO:

Begin at the Northwest corner of the Northeast Quarter of the Southwest Quarter of Section 21, Township 2 South, Range 1 East, Leon County, Florida, and run thence North 00 degrees 06 minutes 18 seconds East 260.77 feet to the Point of Beginning. From said Point of Beginning continue North 00 degrees 06 minutes 18 seconds East 60 feet, thence run North 89 degrees 50 minutes 47 seconds West 1160.21 feet to a point on the Easterly right of way boundary of State Road No. 363, thence run South 10 degrees 15 minutes 24 seconds East along said right of way 61 feet thence leaving said Right of Way run south 89 degrees 50 minutes 47 seconds East 1149.24 feet to the Point of Beginning, containing 1.59 acres, more or less.

EXHIBIT " B " COMMON AREA

PAGE 2 of 3

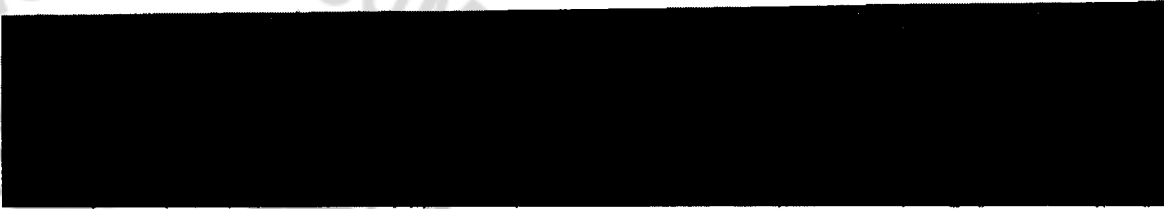

UNOFFICIAL DOCUMENT

DR1117PG1278

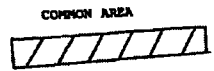
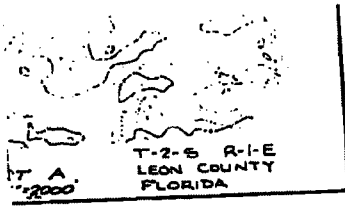
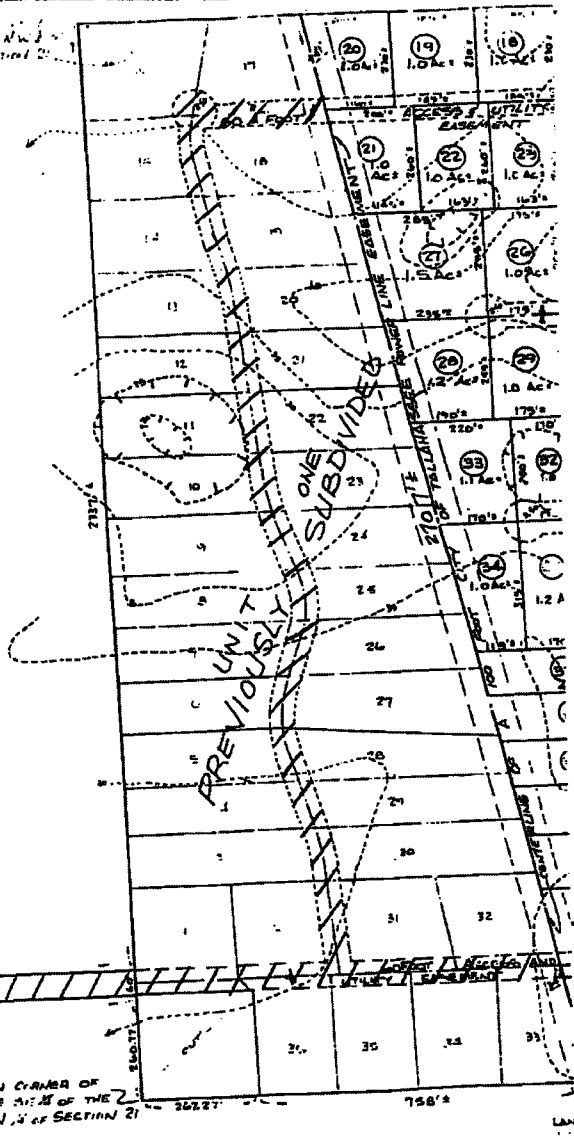

EXHIBIT "B" COMMON AREA
PAGE 3 of 3

STATE POINT No. 363

1160'±
1149'±

S.W. CORNER OF
THE NE 1/4 OF THE
N.W. 1/4 OF SECTION 21



RECORDING NOTICE
Document legibility unsatisfactory
for clear reproduction in the public
records.

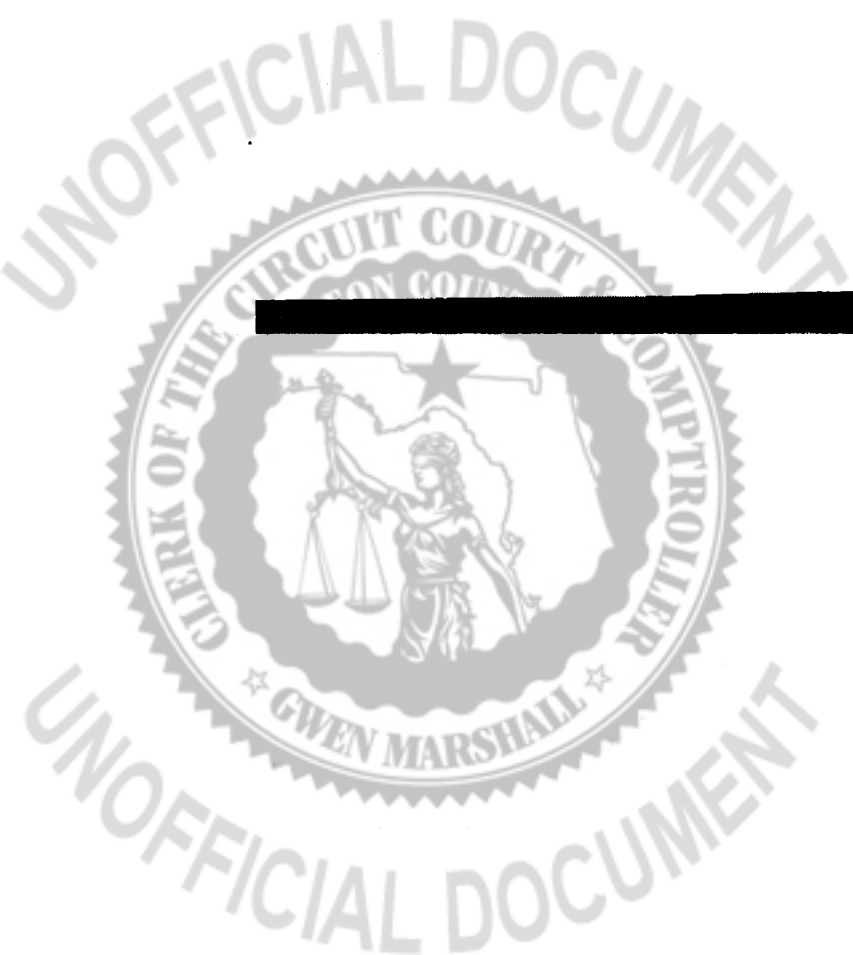



NOBLES, VARNUM & ASSOCIATES, INC.

CIVIL ENGINEERING • LAND SURVEYING • LANDSCAPE ARCHITECTURE
LAND USE PLANNING • ENVIRONMENTAL ANALYSIS & PERMITTING

EXHIBIT A

NVA No. 0456-4
September 26, 1994

LEGAL DESCRIPTION NATURAL WELLS - UNIT 4

Commence at a concrete monument marking the Northwest corner of the Northeast quarter of the Northwest quarter of Section 21, Township 2 South, Range 1 East, Leon County, Florida thence run South 89 degrees 53 minutes 36 seconds East 499.75 feet to a concrete monument marking the Northwest corner of Natural Wells - Unit 2, a subdivision as recorded in Plat Book 9, Page 73 of the Public Records of Leon County, Florida, thence run South 89 degrees 52 minutes 30 seconds East along the north boundary of said Natural Wells - Unit 2 a distance of 1031.00 feet to a concrete monument marking the Northeast corner of said Natural Wells - Unit 2, thence continue South 89 degrees 52 minutes 30 seconds East along the north boundary of Natural Wells - Unit 3, a subdivision as recorded in Plat Book 10, Page 31 of the Public Records of Leon County, Florida a distance of 306.67 feet, thence run South 89 degrees 56 minutes 46 seconds East along the north boundary of said Natural Wells - Unit 3 a distance of 293.33 feet to a concrete monument marking the Northwest corner of said Natural Wells - Unit 3 and the POINT OF BEGINNING. From said POINT OF BEGINNING thence continue South 89 degrees 56 minutes 46 seconds East 546.60 feet, thence run South 00 degrees 06 minutes 33 seconds West 1329.09 feet to a found concrete monument, thence run North 89 degrees 55 minutes 38 seconds West 126.88 feet, thence run South 209.32 feet, thence run North 89 degrees 40 minutes 59 seconds West 52.20 feet, thence run South 800.01 feet, thence run South 47 degrees 27 minutes 19 seconds West 88.21 feet, thence leaving said south right of way run South 263.60 feet, thence run North 89 degrees 40 minutes 59 seconds West 400.01 feet to a concrete monument marking the Southeast corner of said Natural Wells - Unit 3, thence along the east boundary of said Natural Wells - Unit 3 run North 263.60 feet, thence run North 15 degrees 48 minutes 11 seconds West 62.46 feet, thence leaving said north right of way boundary and along the east boundary of said Natural Wells - Unit 3 run North 800.01 feet, thence run North 12 degrees 03 minutes 26 seconds East 102.14 feet, thence run North 17 degrees 50 minutes 46 seconds East 104.87 feet, thence run North 20 degrees 08 minutes 43 seconds East 106.30 feet, thence run North 972.22 feet, thence run North 24 degrees 10 minutes 41 seconds East 65.73 feet, thence leaving said north right of way boundary run North 204.12 feet to the POINT OF BEGINNING, containing 31.66 acres more or less.

OR 1856 PG 2206

3559 Timberlane School Road • Tallahassee, Florida 32312 • Phone 904-668-3211 • Fax 904-668-3106
FLORIDA LICENSE NUMBER LC 0340

Exhibit C

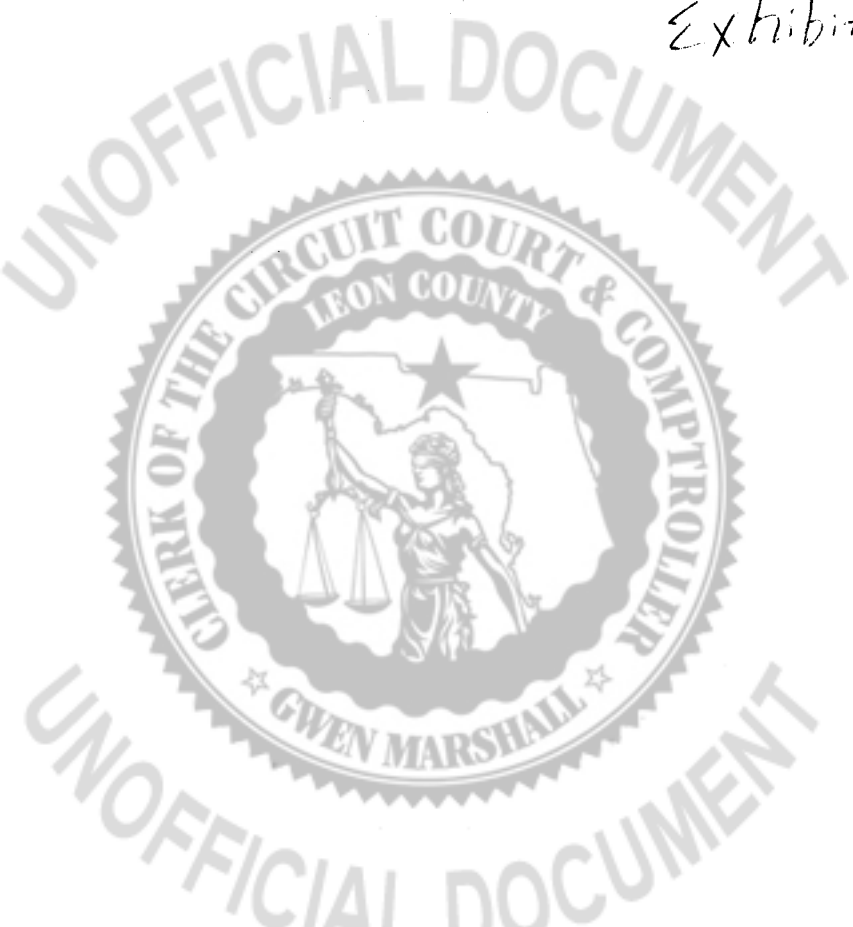

N **NOBLES, VARNUM & ASSOCIATES, INC.**
 CIVIL ENGINEERING • LAND SURVEYING • LANDSCAPE ARCHITECTURE
 LAND USE PLANNING • ENVIRONMENTAL ANALYSIS & PERMITTING
EXHIBIT B

NVA No. 0456-4
September 30, 1994

**LEGAL DESCRIPTION
NATURAL WELLS - UNIT 5**

Commence at a concrete monument marking the Northwest corner of the Northeast quarter of the Northwest quarter of Section 21, Township 2 South, Range 1 East, Leon County, Florida thence run South 89 degrees 53 minutes 36 seconds East 499.75 feet to a concrete monument marking the Northwest corner of Natural Wells - Unit 2, a subdivision as recorded in Plat Book 9, Page 73 of the Public Records of Leon County, Florida, thence run South 89 degrees 52 minutes 30 seconds East along the north boundary of said Natural Wells - Unit 2 a distance of 1031.00 feet to a concrete monument marking the Northeast corner of said Natural Wells - Unit 2, thence continue South 89 degrees 52 minutes 30 seconds East along the north boundary of Natural Wells - Unit 3, a subdivision as recorded in Plat Book 10, Page 31 of the Public Records of Leon County, Florida a distance of 306.67 feet, thence run South 89 degrees 56 minutes 46 seconds East along the north boundary of said Natural Wells - Unit 3 a distance of 293.33 feet to a concrete monument marking the Northwest corner of said Natural Wells - Unit 3, thence continue South 89 degrees 56 minutes 46 seconds East 546.60 feet, thence run South 00 degrees 06 minutes 33 seconds West 1329.09 feet to a found concrete monument and the POINT OF BEGINNING. From said POINT OF BEGINNING thence run South 89 degrees 59 minutes 44 seconds East 1326.96 feet to a found concrete monument, thence run South 00 degrees 59 minutes 07 seconds West 1340.78 feet, thence run North 89 degrees 40 minutes 59 seconds West 1548.00 feet, thence run North 263.60 feet, thence run North 47 degrees 27 minutes 19 seconds East 88.21 feet, thence run North 800.01 feet, thence run South 89 degrees 40 minutes 59 seconds East 52.20 feet, thence run North 209.32 feet, thence run South 89 degrees 55 seconds 38 minutes East 126.88 feet to the POINT OF BEGINNING, containing 46.04 acres more or less.

OR 1856 PG 2207

Exhibit C

3559 Timberlane School Road • Tallahassee, Florida 32312 • Phone 904-668-3211 • Fax 904-668-3106
FLORIDA LICENSE NUMBER LC 0280



UNOFFICIAL DOCUMENT

Exhibit D

parcel id	location	legal1	legal2	legal3	legal4
332103 A0030:	2131 NATURAL WELLS DR	NATURAL WELLS UNIT 2	LOT 3 BLOCK A	OR 1895/2228	
332103 A0050:	2141 NATURAL WELLS DR	NATURAL WELLS UNIT 2	LOT 5 BLOCK A	OR 1172/143 1196/1326 1634/1154	OR 2063/2144
332103 A0180:	2277 NATURAL WELLS DR	21 25 1E	NATURAL WELLS UNIT 5	LOT 18 BLOCK A .61 A	OR 2203/1436
332103 B0100:	10059 BLUE WATERS RD	NATURAL WELLS UNIT 2	LOT 10 BLOCK B	OR 1319/667 2294/1754 CT	
332103 B0110:	10057 BLUE WATERS RD	NATURAL WELLS UNIT 2	LOT 11 BLOCK B	OR 1172/143 1196/1326 2067/1269	
332103 B0180:	10088 SPRING SINK RD	NATURAL WELLS UNIT 3	LOT 18 BLOCK B	OR 1172/143 1196/1326 2067/1269	
332103 C0120:	2670 LOW RIDGE LN	NATURAL WELLS UNIT 2	LOT 12 BLOCK C	OR 1933/2191 2146/1249	
332103 C0130:	2666 LOW RIDGE LN	NATURAL WELLS UNIT 2	LOT 13 BLOCK C	OR 1394/2276	
332103 C0190:	10074 SPRING SINK RD	NATURAL WELLS UNIT 3	LOT 19 BLOCK C	OR 1172/143 1196/1326 1634/1154	OR 1967/1072
332103 C0200:	10068 SPRING SINK RD	NATURAL WELLS UNIT 3	LOT 20 BLOCK C	OR 1172/143 1196/1326 1634/1154	OR 2147/935 2303/1315
332103 C0340:	2740 JUNCTURE DR	21 25 1E	NATURAL WELLS UNIT 4	LOT 34 BLOCK C	OR 2203/1436 2341/2254
332103 A0060:	2147 NATURAL WELLS DR	NATURAL WELLS UNIT 3	LOT 6 BLOCK A	OR 1172/143 1196/1326 1634/1154	OR 2149/68
332103 B0040:	10091 BLUE WATERS RD	NATURAL WELLS UNIT 2	LOT 4 BLOCK B	OR 1367/461 1469/437 2149/72	
332103 B0060:	10083 BLUE WATERS RD	NATURAL WELLS UNIT 2	LOT 6 BLOCK B	OR 1309/711 1690/2103 2067/1269	
332103 C0070:	10027 BLUE WATERS RD	NATURAL WELLS UNIT 2	LOTS 7 & 8 BLOCK C	OR 1290/1331	
332103 C0110:	2674 LOW RIDGE LN	NATURAL WELLS UNIT 2	LOT 11 BLOCK C	OR 1933/2191 2146/1249	
332103 C0260:	2708 JUNCTURE DR	NATURAL WELLS UNIT 3	LOT 26 BLOCK C	OR 1172/143 1196/1326 1531/1771	OR 1624/1285 2370/1961
332103 C0270:	2712 JUNCTURE DR	NATURAL WELLS UNIT 3	LOT 27 BLOCK C	OR 1430/1627 2162/1015	RP 488805
332103 C0360:	10039 GREEN FOUNTAIN RD	21 25 1E	NATURAL WELLS UNIT 4	LOT 36 BLOCK C	OR 2093/1961 2101/853 3694/488
332103 C0500:	10095 GREEN FOUNTAIN RD	21 25 1E	NATURAL WELLS UNIT 4	LOT 50 BLOCK C	OR 2203/1433 2377/164
332103 A0120:	2229 NATURAL WELLS DR	21 25 1E	NATURAL WELLS UNIT 4	LOT 12 BLOCK A	OR 2203/1436
332103 A0140:	2245 NATURAL WELLS DR	21 25 1E	NATURAL WELLS UNIT 5	LOT 14 BLOCK A 1.21 A	OR 2203/1433
332103 A0150:	2253 NATURAL WELLS DR	21 25 1E	NATURAL WELLS UNIT 5	LOT 15 BLOCK A .61 A	OR 2203/1436
332103 A0160:	2261 NATURAL WELLS DR	21 25 1E	NATURAL WELLS UNIT 5	LOT 16 BLOCK A .61 A	OR 2203/1433
332103 A0220:	2313 NATURAL WELLS DR	21 25 1E	NATURAL WELLS UNIT 5	LOT 22 BLOCK A .61 A	OR 2203/1433
332103 A0240:	2329 NATURAL WELLS DR	21 25 1E	NATURAL WELLS UNIT 5	LOT 24 BLOCK A .61 A	OR 2203/1436
332103 B0020:	2142 NATURAL WELLS DR	NATURAL WELLS UNIT 2	LOT 2 BLOCK B	OR 1172/143 1196/1326 1937/1525	
332103 B0050:	10087 BLUE WATERS RD	NATURAL WELLS UNIT 2	LOT 5 BLOCK B	OR 1172/143 1196/1326 2203/1439	
332103 B0070:	10077 BLUE WATERS RD	NATURAL WELLS UNIT 2	LOT 7 BLOCK B	OR 1381/1827	
332103 B0200:	2146 NATURAL WELLS DR	NATURAL WELLS UNIT 3	LOT 20 BLOCK B	OR 1172/143 1196/1326 2067/1269	
332103 B0210:	10096 SPRING SINK RD	NATURAL WELLS UNIT 3	LOT 21 BLOCK B	OR 1514/388	
332103 C0020:	10045 BLUE WATERS RD	NATURAL WELLS UNIT 2	LOT 2 BLOCK C	OR 1300/225	
332103 C0180:	2694 BROAD LEAF DR	NATURAL WELLS UNIT 3	LOT 18 BLOCK C	OR 1757/1347 1926/2365	RP 53365/533651
332103 C0220:	10060 SPRING SINK RD	NATURAL WELLS UNIT 3	LOT 22 BLOCK C	OR 1172/143 1196/1326 1933/352	
332103 C0240:	10054 SPRING SINK RD	NATURAL WELLS UNIT 3	LOT 24 BLOCK C	OR 1551/1862 2165/1924	
332103 C0320:	2732 JUNCTURE DR	21 25 1E	NATURAL WELLS UNIT 4	LOT 32 BLOCK C	OR 2203/1433 2263/1257 1259
332103 C0350:	2744 JUNCTURE DR	21 25 1E	NATURAL WELLS UNIT 4	LOT 35 BLOCK C	OR 2203/1433 2341/2272
332103 C0510:	10099 GREEN FOUNTAIN RD	21 25 1E	NATURAL WELLS UNIT 4	LOT 51 BLOCK C	OR 2203/1439
332103 A0040:	2135 NATURAL WELLS DR	NATURAL WELLS UNIT 2	LOT 4 BLOCK A	OR 1172/143 1196/1326 1634/1154	OR 2074/1981
332103 A0190:	2285 NATURAL WELLS DR	21 25 1E	NATURAL WELLS UNIT 5	LOT 19 BLOCK A .61 A	OR 2203/1433
332103 A0230:	2321 NATURAL WELLS DR	21 25 1E	NATURAL WELLS UNIT 5	LOT 23 BLOCK A .61 A	OR 2203/1439
332103 A0260:	2345 NATURAL WELLS DR	21 25 1E	NATURAL WELLS UNIT 5	LOT 26 BLOCK A 1.51 A	OR 2341/2300
332103 B0170:	10086 SPRING SINK RD	NATURAL WELLS UNIT 3	LOT 17 BLOCK B	OR 1172/143 1196/1326 1949/157	
332103 C0010:	10049 BLUE WATERS RD	NATURAL WELLS UNIT 2	LOT 1 BLOCK C	OR 1380/1827 1601/1600 1982/376	
332103 C0310:	2728 JUNCTURE DR	21 25 1E	NATURAL WELLS UNIT 4	LOT 31 BLOCK C	OR 2203/1436
332103 C0520:	10103 GREEN FOUNTAIN RD	21 25 1E	NATURAL WELLS UNIT 4	LOT 52 BLOCK C	OR 2203/1436 2341/2264
332103 C0570:	10188 SANDYROCK LN	21 25 1E	NATURAL WELLS UNIT 5	LOT 57 BLOCK C 0.48 A	OR 1940/115
332103 A0010:	2123 NATURAL WELLS DR	NATURAL WELLS UNIT 2	LOT 1 BLOCK A	OR 1466/1284 1635/374 2067/1269	
332103 A0020:	2127 NATURAL WELLS DR	NATURAL WELLS UNIT 2	LOT 2 BLOCK A	OR 1392/1448	RP-490636-RP-490637
332103 A0250:	2337 NATURAL WELLS DR	21 25 1E	NATURAL WELLS UNIT 5	LOT 25 BLOCK A .60 A	OR 2203/1433
332103 B0010:	10099 BLUE WATERS RD	NATURAL WELLS UNIT 2	LOT 1 BLOCK B	OR 1341/2310 1757/1796 2203/1436	
332103 C0060:	10029 BLUE WATERS RD	NATURAL WELLS UNIT 2	LOT 6 BLOCK C	OR 1271/1070 1574/2110 2067/1269	
332103 C0160:	0 LOW RIDGE LN	NATURAL WELLS UNIT 2	LOT 16 BLOCK C	OR 1248/2131	
332103 C0390:	10051 GREEN FOUNTAIN RD	21 25 1E	NATURAL WELLS UNIT 4	LOT 39 BLOCK C	OR 2203/1433 2341/2272
332103 C0460:	10079 GREEN FOUNTAIN RD	21 25 1E	NATURAL WELLS UNIT 4	LOT 46 BLOCK C	OR 2069/36
332103 A0130:	2237 NATURAL WELLS DR	21 25 1E	NATURAL WELLS UNIT 4	LOT 13 BLOCK A	OR 2203/1436
332103 A0170:	2269 NATURAL WELLS DR	21 25 1E	NATURAL WELLS UNIT 5	LOT 17 BLOCK A .61 A	OR 2203/1433
332103 A0210:	2305 NATURAL WELLS DR	21 25 1E	NATURAL WELLS UNIT 5	LOT 21 BLOCK A .61 A	OR 2203/1436
332103 B0030:	10095 BLUE WATERS RD	NATURAL WELLS UNIT 2	LOT 3 BLOCK B	OR 1807/658 2069/781 2122/1143	OR 2337/1744 2318/368
332103 B0090:	10067 BLUE WATERS RD	NATURAL WELLS UNIT 2	LOT 9 BLOCK B (.622 AC)	OR 1172/143 1196/1326 2067/1269	
332103 B0120:	10053 BLUE WATERS RD	NATURAL WELLS UNIT 2	LOT 12 BLOCK B	OR 1595/1496	
332103 B0190:	10072 SPRING SINK RD	NATURAL WELLS UNIT 3	LOT 19 BLOCK B	OR 1498/229	RP-533859-RP-533860
332103 C0100:	2678 LOW RIDGE LN	NATURAL WELLS UNIT 2	LOT 10 BLOCK C	OR 1249/259 1487/997 2057/26	
332103 C0170:	2650 LOW RIDGE LN	NATURAL WELLS UNIT 2	LOT 17 BLOCK C	OR 1248/2131	
332103 C0330:	2736 JUNCTURE DR	21 25 1E	NATURAL WELLS UNIT 4	LOT 33 BLOCK C	OR 2203/1433 2263/1257 1259
332103 C0440:	10071 GREEN FOUNTAIN RD	21 25 1E	NATURAL WELLS UNIT 4	LOT 44 BLOCK C	OR 2203/1436
332103 C0550:	10115 GREEN FOUNTAIN RD	21 25 1E	NATURAL WELLS UNIT 4	LOT 55 BLOCK C	OR 2069/36
332103 C0560:	10192 SANDYROCK LN	21 25 1E	NATURAL WELLS UNIT 5	LOT 56 BLOCK C 0.48 A	
332103 B0080:	10073 BLUE WATERS RD	NATURAL WELLS UNIT 2	LOT 8 BLOCK B	OR 1851/1260	RP 368056 RP368057
332103 B0140:	10080 SPRING SINK RD	NATURAL WELLS UNIT 3	LOT 14 BLOCK B	OR 1172/143 1196/1326 1634/1154	OR 2147/935
332103 B0150:	10082 SPRING SINK RD	NATURAL WELLS UNIT 3	LOT 15 BLOCK B	OR 1903/962	
332103 B0160:	10084 SPRING SINK RD	NATURAL WELLS UNIT 3	LOT 16 BLOCK B	OR 1172/143 1196/1326 2011/575	
332103 C0140:	2662 LOW RIDGE LN	NATURAL WELLS UNIT 2	LOT 14 BLOCK C	OR 1650/380	
332103 C0150:	2658 LOW RIDGE LN	NATURAL WELLS UNIT 2	LOT 15 BLOCK C	OR 1317/1404	
332103 C0230:	10056 SPRING SINK RD	NATURAL WELLS UNIT 3	LOT 23 BLOCK C	OR 1172/143 1196/1326 1599/1607	OR 1809/2025 1984/659 2239/642
332103 C0250:	2704 JUNCTURE DR	NATURAL WELLS UNIT 3	LOT 25 BLOCK C	OR 1172/143 1196/1326 1634/758	OR 1859/1561 2010/1529 2415/2375
332103 C0290:	2720 JUNCTURE DR	NATURAL WELLS UNIT 3	LOT 29 BLOCK C	OR 1772/847	
332103 C0380:	10047 GREEN FOUNTAIN RD	21 25 1E	NATURAL WELLS UNIT 4	LOT 38 BLOCK C	OR 2203/1436 2263/1257 1259
332103 C0410:	0 GREEN FOUNTAIN RD	21 25 1E	NATURAL WELLS UNIT 4	LOT 41 BLOCK C	OR 2203/1436

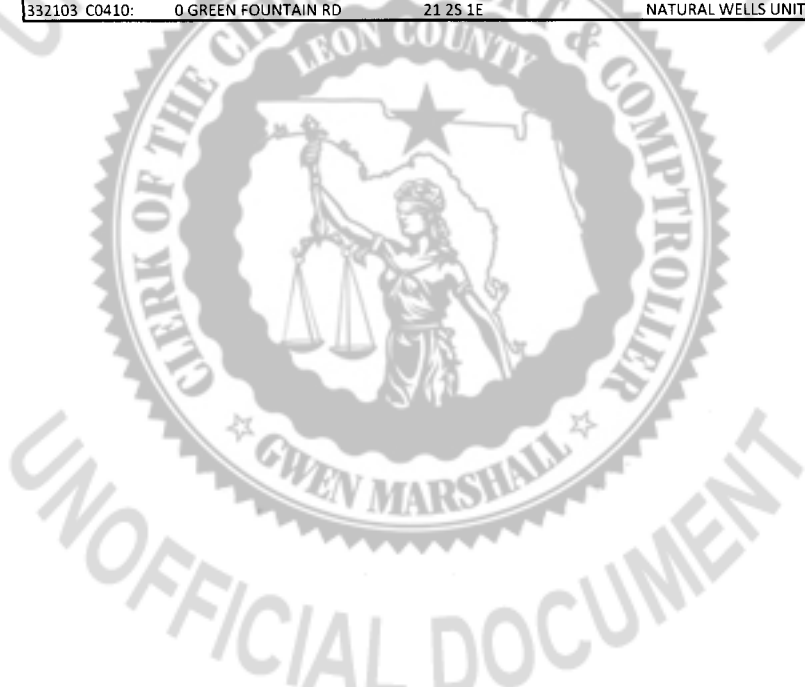

Exhibit D

332103 C0420:	0 GREEN FOUNTAIN RD	21 2S 1E	NATURAL WELLS UNIT 4	LOT 42	BLOCK C	OR 2203/1433 2377/164
332103 C0430:	10067 GREEN FOUNTAIN RD	21 2S 1E	NATURAL WELLS UNIT 4	LOT 43	BLOCK C	OR 2203/1436
332103 C0450:	10075 GREEN FOUNTAIN RD	21 2S 1E	NATURAL WELLS UNIT 4	LOT 45	BLOCK C	OR 2069/36
332103 C0480:	10087 GREEN FOUNTAIN RD	21 2S 1E	NATURAL WELLS UNIT 4	LOT 48	BLOCK C	OR 2203/1439
332103 C0530:	10107 GREEN FOUNTAIN RD	21 2S 1E	NATURAL WELLS UNIT 4	LOT 53	BLOCK C	OR 2203/1433 2341/2260
332103 A0070:	2151 NATURAL WELLS DR	NATURAL WELLS UNIT 3	LOT 7	BLOCK A	OR 1172/143 1196/1326 1634/1154	OR 2085/2066 2278/2097 CT
332103 A0080:	2207 NATURAL WELLS DR	NATURAL WELLS UNIT 3	LOT 8	BLOCK A	OR 1172/143 1196/1326 1634/1154	OR 2149/68
332103 A0090:	2211 NATURAL WELLS DR	NATURAL WELLS UNIT 3	LOT 9	BLOCK A	OR 1172/143 1196/1326 1634/1154	OR 2196/1630
332103 A0200:	2293 NATURAL WELLS DR	21 2S 1E	NATURAL WELLS UNIT 5	LOT 20	BLOCK A .61 A	OR 2203/1439
332103 B0130:	10078 SPRING SINK RD	NATURAL WELLS UNIT 3	LOT 13	BLOCK B	OR 1637/1401 1797/1365 2147/935	
332103 C0030:	10041 BLUE WATERS RD	NATURAL WELLS UNIT 2	LOT 3	BLOCK C	OR 1172/143 1196/1326 2067/1269	
332103 C0040:	10037 BLUE WATERS RD	NATURAL WELLS UNIT 2	LOTS 4 & 5	BLOCK C	OR 1731/1287	
332103 C0090:	2682 LOW RIDGE LN	NATURAL WELLS UNIT 2	LOT 9	BLOCK C	OR 1172/143 1196/1326 2149/72	
332103 C0210:	10066 SPRING SINK RD	NATURAL WELLS UNIT 3	LOT 21	BLOCK C	OR 1172/143 1196/1326 1940/111	OR 2298/818
332103 C0280:	2716 JUNCTURE DR	NATURAL WELLS UNIT 3	LOT 28	BLOCK C	OR 1437/475 1915/360 2392/408	
332103 C0300:	2724 JUNCTURE DR	NATURAL WELLS UNIT 3	LOT 30	BLOCK C	OR 1804/329 2116/1576 2188/1131 CT	OR 2347/1615 1616 2401/296 CT
332103 C0370:	10043 GREEN FOUNTAIN RD	21 2S 1E	NATURAL WELLS UNIT 4	LOT 37	BLOCK C	OR 2203/1433 2263/1257 1259 2467/
332103 C0400:	10055 GREEN FOUNTAIN RD	21 2S 1E	NATURAL WELLS UNIT 4	LOT 40	BLOCK C	OR 2203/1436 2263/1257 1259
332103 C0470:	10083 GREEN FOUNTAIN RD	21 2S 1E	NATURAL WELLS UNIT 4	LOT 47	BLOCK C	OR 2203/1433 2377/164
332103 C0490:	10091 GREEN FOUNTAIN RD	21 2S 1E	NATURAL WELLS UNIT 4	LOT 49	BLOCK C	OR 2203/1436
332103 C0540:	10111 GREEN FOUNTAIN RD	21 2S 1E	NATURAL WELLS UNIT 4	LOT 54	BLOCK C	OR 2069/36 2269/1098
332103 C0630:	0 SANDYROCK LN	21 2S 1E	NATURAL WELLS UNIT 5	LOT 63	BLOCK C .48 A	OR 2203/1436
332103 C0800:	10266 SYPHON DR	21 2S 1E	NATURAL WELLS UNIT 5	LOT 80	BLOCK C .48 A	OR 2203/1431 2227/1335 2270/1538
332103 C0830:	10254 SYPHON DR	21 2S 1E	NATURAL WELLS UNIT 5	LOT 83	BLOCK C .62 A	OR 2203/1431 2227/1335 2341/2260
332103 C0870:	10257 SYPHON DR	21 2S 1E	NATURAL WELLS UNIT 5	LOT 87	BLOCK C .48 A	OR 2203/1431 2227/1335 2270/1561
332103 D0010:	2651 LOW RIDGE LN	NATURAL WELLS UNIT 2	LOT 1	BLOCK D	OR 1774/689	
332103 D0020:	2657 LOW RIDGE LN	NATURAL WELLS UNIT 2	LOT 2	BLOCK D	OR 1560/716	
332103 D0050:	10024 BLUE WATERS RD	NATURAL WELLS UNIT 2	LOT 5	BLOCK D	OR 1364/530 2016/1413 2132/1679	
332103 D0130:	2665 BLUE WATERS CT	NATURAL WELLS UNIT 2	LOT 13	BLOCK D	OR 1327/2276 2501/2032	RP-483642
332103 E0020:	10061 SPRING SINK RD	NATURAL WELLS UNIT 3	LOT 2	BLOCK E	OR 1172/143 1196/1326 2086/1889	OR 2096/2287 2245/878
332103 E0040:	10069 SPRING SINK RD	NATURAL WELLS UNIT 3	LOT 4	BLOCK E	OR 1172/143 1196/1326 1857/1386	OR 1960/95
332103 C0640:	10160 SANDYROCK LN	21 2S 1E	NATURAL WELLS UNIT 5	LOT 64	BLOCK C .48 A	OR 2203/1433 2341/2308
332103 C0770:	10278 SYPHON DR	21 2S 1E	NATURAL WELLS UNIT 5	LOT 77	BLOCK C .48 A	OR 2203/1439 2341/2268
332103 C0880:	10261 SYPHON DR	21 2S 1E	NATURAL WELLS UNIT 5	LOT 88	BLOCK C .48 A	OR 2203/1431&1464 2227/1335 2270/
332103 C0940:	0 SYPHON DR	21 2S 1E	NATURAL WELLS UNIT 5	LOT 94	BLOCK C .48 A	OR 2203/1439
332103 C1020:	0 CRYSTALLINE CT	21 2S 1E	NATURAL WELLS UNIT 5	LOT 102	BLOCK C .48 A	OR 2203/1431 2227/1335
332103 D0080:	2674 BLUE WATERS CT	NATURAL WELLS UNIT 2	LOT 8	BLOCK D	OR 1292/890 1430/2082 1690/413	OR 1829/216 1836/1566 2040/524
332103 D0280:	2128 NATURAL WELLS DR	NATURAL WELLS UNIT 2	LOT 28	BLOCK D	OR 1381/1271 1822/1596	RP-489453-RP-489454
332103 E0050:	10071 SPRING SINK RD	NATURAL WELLS UNIT 3	LOT 5	BLOCK E	OR 1172/143 1196/1326 2147/939	
332103 E0210:	10108 GREEN FOUNTAIN RD	21 2S 1E	NATURAL WELLS UNIT 4	LOT 21	BLOCK E	OR 2203/1433 2341/2260
332103 E0240:	0 GREEN FOUNTAIN RD	21 2S 1E	NATURAL WELLS UNIT 4	LOT 24	BLOCK E	OR 2203/1436
332103 C0710:	10175 SANDYROCK LN	21 2S 1E	NATURAL WELLS UNIT 5	LOT 71	BLOCK C .48 A	OR 2203/1439 2341/2304
332103 C0780:	10274 SYPHON DR	21 2S 1E	NATURAL WELLS UNIT 5	LOT 78	BLOCK C .48 A	OR 2203/1436 2270/1538
332103 C0840:	10250 SYPHON DR	21 2S 1E	NATURAL WELLS UNIT 5	LOT 84	BLOCK C .48 A	OR 2203/1431 2227/1335 2341/2264
332103 C0920:	10279 SYPHON DR	21 2S 1E	NATURAL WELLS UNIT 5	LOT 92	BLOCK C .48 A	OR 2149/72 2373/1949
332103 C0960:	0 CRYSTALLINE CT	21 2S 1E	NATURAL WELLS UNIT 5	LOT 96	BLOCK C .48 A	OR 2203/1431 2227/1335
332103 C1030:	10352 CRYSTALLINE CT	21 2S 1E	NATURAL WELLS UNIT 5	LOT 103	BLOCK C .49 A	OR 2203/1431 2227/1335
332103 C1040:	0 CRYSTALLINE CT	21 2S 1E	NATURAL WELLS UNIT 5	LOT 104	BLOCK C .53 A	OR 2203/1431 2227/1335
332103 D0060:	10032 BLUE WATERS RD	NATURAL WELLS UNIT 2	LOT 6	BLOCK D	OR 1558/1477 1563/425 426	RP-533956-RP-533957
332103 D0150:	10044 BLUE WATERS RD	NATURAL WELLS UNIT 2	LOT 15	BLOCK D	OR 1785/1828	
332103 D0270:	10096 BLUE WATERS RD	NATURAL WELLS UNIT 2	LOT 27	BLOCK D	OR 1579/1450	
332103 E0070:	10075 SPRING SINK RD	NATURAL WELLS UNIT 3	LOT 7	BLOCK E	OR 1472/1277 2054/569	
332103 E0100:	10081 SPRING SINK RD	NATURAL WELLS UNIT 3	LOT 10	BLOCK E	OR 1498/1571	
332103 E0110:	10083 SPRING SINK RD	NATURAL WELLS UNIT 3	LOT 11	BLOCK E	OR 1172/143 1196/1326 1634/1154	OR 1961/2373 2399/1066 CT
332103 E0150:	10091 SPRING SINK RD	NATURAL WELLS UNIT 3	LOT 15	BLOCK E	OR 1172/143 1196/1326 2147/939	
332103 C0590:	10180 SANDYROCK LN	21 2S 1E	NATURAL WELLS UNIT 5	LOT 59	BLOCK C .48 A	OR 1940/115
332103 C0620:	10168 SANDYROCK LN	21 2S 1E	NATURAL WELLS UNIT 5	LOT 62	BLOCK C .48 A	OR 2203/1439 2348/401
332103 C0670:	10159 SANDYROCK LN	21 2S 1E	NATURAL WELLS UNIT 5	LOT 67	BLOCK C .51 A	OR 2203/1433 2341/2308
332103 C0720:	10179 SANDYROCK LN	21 2S 1E	NATURAL WELLS UNIT 5	LOT 72	BLOCK C .97 A	OR 2203/1436 2343/33
332103 C0730:	10187 SANDYROCK LN	21 2S 1E	NATURAL WELLS UNIT 5	LOT 73	BLOCK C .48 A	OR 2203/1433 2341/2308
332103 D0170:	10050 BLUE WATERS RD	NATURAL WELLS UNIT 2	LOT 17	BLOCK D	OR 1369/2180	
332103 D0180:	10054 BLUE WATERS RD	NATURAL WELLS UNIT 2	LOT 18	BLOCK D	OR 1339/955 1495/1646 2149/72	
332103 D0250:	10090 BLUE WATERS RD	NATURAL WELLS UNIT 2	LOT 25	BLOCK D	OR 1308/672 1347/2239 1399/1835	OR 2263/1257 1259
332103 E0030:	10065 SPRING SINK RD	NATURAL WELLS UNIT 3	LOT 3	BLOCK E	OR 1497/628	
332103 E0080:	10077 SPRING SINK RD	NATURAL WELLS UNIT 3	LOT 8	BLOCK E	OR 1172/143 1196/1326 1634/1154	OR 2147/935
332103 E0160:	10093 SPRING SINK RD	NATURAL WELLS UNIT 3	LOT 16	BLOCK E	OR 1750/2021	
332103 E0190:	10116 GREEN FOUNTAIN RD	21 2S 1E	NATURAL WELLS UNIT 4	LOT 19	BLOCK E	OR 2069/36
332103 C0660:	0 SANDYROCK LN	21 2S 1E	NATURAL WELLS UNIT 5	LOT 66	BLOCK C .49 A	
332103 C0690:	10167 SANDYROCK LN	21 2S 1E	NATURAL WELLS UNIT 5	LOT 69	BLOCK C .48 A	OR 2203/1436 2343/33
332103 C0810:	10262 SYPHON DR	21 2S 1E	NATURAL WELLS UNIT 5	LOT 81	BLOCK C .48 A	OR 2203/1431 2227/1335 2270/1561
332103 C0820:	0 SYPHON DR	21 2S 1E	NATURAL WELLS UNIT 5	LOT 82	BLOCK C .48 A	OR 2203/1431 2227/1335 2270/1538
332103 C0900:	10269 SYPHON DR	21 2S 1E	NATURAL WELLS UNIT 5	LOT 90	BLOCK C	OR 2203/1464 2204/1431 2227/1335
332103 C0930:	10283 SYPHON DR	21 2S 1E	NATURAL WELLS UNIT 5	LOT 93	BLOCK C .48 A	OR 2149/72
332103 C0980:	0 CRYSTALLINE CT	21 2S 1E	NATURAL WELLS UNIT 5	LOT 98	BLOCK C .48 A	OR 2203/1431 2227/1335
332103 D0040:	0 LOW RIDGE LN	NATURAL WELLS UNIT 2	LOT 4	BLOCK D	OR 1737/818 2203/1433	
332103 D0100:	2660 BLUE WATERS CT	NATURAL WELLS UNIT 2	LOTS 9 & 10	BLOCK D	OR 1818/58 4755/338(UT)	
332103 D0110:	2659 BLUE WATERS CT	NATURAL WELLS UNIT 2	LOT 11	BLOCK D	OR 1328/1808 2047/988 2051/51	OR 2194/1522
332103 D0240:	10088 BLUE WATERS RD	NATURAL WELLS UNIT 2	LOT 24	BLOCK D	OR 1362/543	
332103 D0290:	2124 NATURAL WELLS DR	NATURAL WELLS UNIT 2	LOT 29	BLOCK D	OR 1172/143 1196/1326 1634/1154	OR 2196/1630
332103 E0060:	10073 SPRING SINK RD	NATURAL WELLS UNIT 3	LOT 6	BLOCK E	OR 1172/143 1196/1326 1961/1000	

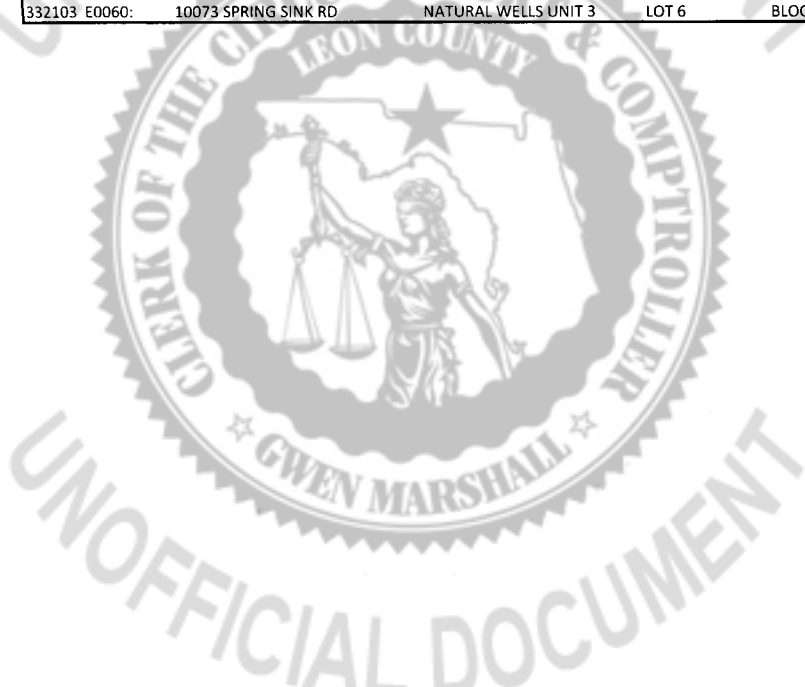

Exhibit D

332103 E0130:	10087 SPRING SINK RD	NATURAL WELLS UNIT 3	LOTS 13 & 14	BLOCK E	OR 1172/143 1196/1326 1941/243	
332103 E0170:	10095 SPRING SINK RD	NATURAL WELLS UNIT 3	LOT 17	BLOCK E	OR 1634/1158 1979/1542	
332103 E0230:	10100 GREEN FOUNTAIN RD	21 2S 1E	NATURAL WELLS UNIT 4		LOT 23 BLOCK E	OR 2203/1433 2426/776
332103 E0260:	10088 GREEN FOUNTAIN RD	21 2S 1E	NATURAL WELLS UNIT 4		LOT 26 BLOCK E	OR 2203/1436
332103 C0580:	10184 SANDYROCK LN	21 2S 1E	NATURAL WELLS UNIT 5		LOT 58 BLOCK C .48 A	OR 1940/115
332103 C0650:	10156 SANDYROCK LN	21 2S 1E	NATURAL WELLS UNIT 5		LOT 65 BLOCK C 0.46 A	OR 2203/1439
332103 C0750:	0 SYPHON DR	21 2S 1E	NATURAL WELLS UNIT 5		LOT 75 BLOCK C .48 A	OR 2203/1436
332103 C0760:	10282 SYPHON DR	21 2S 1E	NATURAL WELLS UNIT 5		LOT 76 BLOCK C .48 A	OR 2203/1439 2341/2268
332103 C0790:	10270 SYPHON DR	21 2S 1E	NATURAL WELLS UNIT 5		LOT 79 BLOCK C .48 A	OR 2203/1431 2227/1335 2270/1561
332103 C0850:	10249 SYPHON DR	21 2S 1E	NATURAL WELLS UNIT 5		LOT 85 BLOCK C .48 A	OR 2203/1431 2227/1335 2341/2260
332103 C0860:	10253 SYPHON DR	21 2S 1E	NATURAL WELLS UNIT 5		LOT 86 BLOCK C .62 A	OR 2203/1431&1464 2227/1335 2341
332103 C0970:	10376 CRYSTALLINE CT	21 2S 1E	NATURAL WELLS UNIT 5		LOT 97 BLOCK C .48 A	OR 2203/1431 2227/1335
332103 C1000:	0 CRYSTALLINE CT	21 2S 1E	NATURAL WELLS UNIT 5		LOT 100 BLOCK C .48 A	OR 2203/1431 2227/1335
332103 D0070:	2678 BLUE WATERS CT	NATURAL WELLS UNIT 2	LOT 7	BLOCK D	OR 1172/143 1196/1326 1550/236	
332103 D0190:	10068 BLUE WATERS RD	NATURAL WELLS UNIT 2	LOT 19	BLOCK D	OR 1332/1847 1666/855 1674/302	OR 1680/844
332103 D0220:	10080 BLUE WATERS RD	NATURAL WELLS UNIT 2	LOT 22	BLOCK D	OR 1560/1359 1823/462	
332103 E0250:	10092 GREEN FOUNTAIN RD	21 2S 1E	NATURAL WELLS UNIT 4		LOT 25 BLOCK E	OR 2203/1433 2426/776
332103 C0610:	10172 SANDYROCK LN	21 2S 1E	NATURAL WELLS UNIT 5		LOT 61 BLOCK C 0.48 A	OR 2203/1433 2341/2272
332103 C0680:	10163 SANDYROCK LN	21 2S 1E	NATURAL WELLS UNIT 5		LOT 68 BLOCK C 0.48 A	OR 2203/1439 2341/2304
332103 C0700:	10171 SANDYROCK LN	21 2S 1E	NATURAL WELLS UNIT 5		LOT 70 BLOCK C .48 A	OR 2203/1433 2341/2308
332103 C1010:	10360 CRYSTALLINE CT	21 2S 1E	NATURAL WELLS UNIT 5		LOT 101 BLOCK C .48 A	OR 2203/1431 2227/1335
332103 D0120:	2661 BLUE WATERS CT	NATURAL WELLS UNIT 2	LOT 12	BLOCK D	OR 1379/1270 1774/1624 2145/224	
332103 D0160:	2663 BLUE WATERS CT	NATURAL WELLS UNIT 2	LOT 16	BLOCK D	OR 1172/143 1196/1326 2263/1257	OR 2263/1259
332103 D0200:	10074 BLUE WATERS RD	NATURAL WELLS UNIT 2	LOT 20	BLOCK D	OR 1399/943	
332103 D0210:	10076 BLUE WATERS RD	NATURAL WELLS UNIT 2	LOT 21	BLOCK D	OR 1361/624	
332103 D0230:	10086 BLUE WATERS RD	NATURAL WELLS UNIT 2	LOT 23	BLOCK D	OR 1248/2127 1477/810	
332103 E0010:	10057 SPRING SINK RD	NATURAL WELLS UNIT 3	LOT 1	BLOCK E	OR 1488/2372 1981/2089 2147/030	
332103 E0090:	10079 SPRING SINK RD	NATURAL WELLS UNIT 3	LOT 9	BLOCK E	OR 1172/143 1196/1326 1634/1154	
332103 C0600:	10176 SANDYROCK LN	21 2S 1E	NATURAL WELLS UNIT 5		LOT 60 BLOCK C 0.48 A	OR 2203/1436 2341/2254
332103 C0740:	2268 NATURAL WELLS DR	21 2S 1E	NATURAL WELLS UNIT 5		LOT 74 BLOCK C .48 A	OR 2203/1439
332103 C0890:	0 SYPHON DR	21 2S 1E	NATURAL WELLS UNIT 5		LOT 89 BLOCK C .48 A	OR 2203/1431 2227/1335 2341/2308
332103 C0910:	10271 SYPHON DR	21 2S 1E	NATURAL WELLS UNIT 5		LOT 91 BLOCK C .48 A	OR 2149/72
332103 C0950:	10384 CRYSTALLINE CT	21 2S 1E	NATURAL WELLS UNIT 5		LOT 95 BLOCK C .48 A	OR 2203/1439
332103 C0990:	10368 CRYSTALLINE CT	21 2S 1E	NATURAL WELLS UNIT 5		LOT 99 BLOCK C .48 A	OR 2203/1431 2227/1335
332103 D0030:	2663 LOW RIDGE LN	NATURAL WELLS UNIT 2	LOT 3	BLOCK D	OR 1336/1077 1489/1893 2098/2039	
332103 D0140:	2679 BLUE WATERS CT	NATURAL WELLS UNIT 2	LOT 14	BLOCK D	OR 1423/340	
332103 D0260:	10094 BLUE WATERS RD	NATURAL WELLS UNIT 2	LOT 26	BLOCK D	OR 1308/672 1347/2240 1474/1796	OR 1967/1082 2195/116
332103 E0120:	10085 SPRING SINK RD	NATURAL WELLS UNIT 3	LOT 12	BLOCK E	OR 1172/143 1196/1326 1972/140	OR 2315/2310 CT 2365/843
332103 E0180:	2212 NATURAL WELLS DR	NATURAL WELLS UNIT 3	LOT 18	BLOCK E	OR 1498/516	
332103 E0200:	10112 GREEN FOUNTAIN RD	21 2S 1E	NATURAL WELLS UNIT 4		LOT 20 BLOCK E	OR 2069/36 2261/65
332103 E0220:	10104 GREEN FOUNTAIN RD	21 2S 1E	NATURAL WELLS UNIT 4		LOT 22 BLOCK E	OR 2203/1436 2341/2254
332103 E0290:	0 GREEN FOUNTAIN RD	21 2S 1E	NATURAL WELLS UNIT 4		LOT 29 BLOCK E	OR 2069/36
332103 E0370:	10044 GREEN FOUNTAIN RD	21 2S 1E	NATURAL WELLS UNIT 4		LOT 37 BLOCK E	OR 2203/1433 2377/164
332103 F0060:	10367 CRYSTALLINE CT	21 2S 1E	NATURAL WELLS UNIT 5		LOT 6 BLOCK F .60 A	OR 1940/114
3321030000140:	10017 N NATURAL WELLS DR	NATURAL WELL UNREC	21 2S 1E 1.11 A		LOT 14	OR 1204/1554
3321030000250:	10064 N NATURAL WELLS DR	NATURAL WELL UNREC	21 2S 1E 1.08 A		LOT 25	OR 1144/1827
3321030000270:	10088 N NATURAL WELLS DR	NATURAL WELL UNREC	21 2S 1E 1.50 A		LOT 27	OR 1055/351 2126/1010
3321030000320:	2118 NATURAL WELLS DR	NATURAL WELL UNREC	21 2S 1E 1.29 A		LOT 32	OR 1723/1558
3321030000340:	2111 NATURAL WELLS DR	NATURAL WELL UNREC	21 2S 1E 1.22 A		LOT 34	OR 1188/836
332103 F0090:	10381 CRYSTALLINE CT	NATURAL WELLS UNIT 5	LOT 9	BLOCK F	OR 2203/1436 2341/2264 2397/712	
3321030000040:	10097 N NATURAL WELLS DR	NATURAL WELL UNREC	21 2S 1E 1.20 A		LOT 4	OR 1534/765
3321030000090:	10057 N NATURAL WELLS DR	NATURAL WELL UNREC	21 2S 1E 1.27 A		LOT 9	OR 1119/1636
3321030000130:	10025 N NATURAL WELLS DR	NATURAL WELL UNREC	21 2S 1E 1.11 A		LOT 13	OR 1221/445
3321030000180:	10008 N NATURAL WELLS DR	NATURAL WELL UNREC	21 2S 1E 1.55 A		LOT 18	OR 1201/2339 1225/2114 2078/1058
332103 F0070:	10371 CRYSTALLINE CT	21 2S 1E	NATURAL WELLS UNIT 5		LOT 7 BLOCK F .60 A	OR 1940/114
3321030000080:	10063 N NATURAL WELLS DR	NATURAL WELL UNREC	21 2S 1E 1.35 A		LOT 8	OR 1216/2218
3321030000110:	0 N NATURAL WELLS DR	NATURAL WELL UNREC	21 2S 1E 1.17 A		LOT 11	OR 1395/1945 1760/390 1979/537
3321030000220:	10040 N NATURAL WELLS DR	NATURAL WELL UNREC	21 2S 1E 1.24 A		LOT 22	OR 1492/1145 1613/1978 2086/1889
3321030000230:	10048 N NATURAL WELLS DR	NATURAL WELL UNREC	21 2S 1E 1.28 A		LOT 23	OR 1208/1364 2386/1029
3321030000260:	10072 N NATURAL WELLS DR	NATURAL WELL UNREC	21 2S 1E 1.22 A		LOT 26	OR 1639/2344
332103 E0380:	10040 GREEN FOUNTAIN RD	21 2S 1E	NATURAL WELLS UNIT 4		LOT 38 BLOCK E	OR 2203/1439 2348/401
3321030000021:	2100 NATURAL WELLS DR	NATURAL WELLS UNIT 1	WEST 1/2 OF LOT 2 .59 A		OR 2307/981	APPROVED FOR 1 INTO 2 ON 2/23/95
3321030000030:	10105 N NATURAL WELLS DR	NATURAL WELL UNREC	21 2S 1E 1.28 A		LOT 3	OR 1613/925 1956/2367 2000/2368
3321030000050:	10089 N NATURAL WELLS DR	NATURAL WELL UNREC	21 2S 1E 1.10 A		LOT 5	OR 1431/1
3321030000060:	10081 N NATURAL WELLS DR	NATURAL WELL UNRECORDED	21 2S 1E 1.09 A		LOT 6	OR 1032/623 2207/1133
3321030000070:	10071 N NATURAL WELLS DR	NATURAL WELL UNREC	21 2S 1E 1.29 A		LOT 7	OR 1798/2314 1865/2167 2346/2068R
3321030000120:	10033 N NATURAL WELLS DR	NATURAL WELL UNREC	21 2S 1E 1.11 A		LOT 12	OR 1395/1945 1760/390 1979/537
332103 E0320:	0 GREEN FOUNTAIN RD	21 2S 1E	NATURAL WELLS UNIT 4		LOT 32 BLOCK E	OR 2203/1433 2377/164
3321030000010:	2090 NATURAL WELLS DR	NATURAL WELL UNREC	21 2S 1E .62 AC		LOT 1-A	OR 1805/1001
3321030000020:	2104 NATURAL WELLS DR	NATURAL WELLS UNIT 1	EAST 1/2 OF LOT 2 .59 A		OR 1279/2131 1682/294	APPROVED FOR 1 INTO 2 ON 2/23/95
3321030000150:	10009 N NATURAL WELLS DR	NATURAL WELL UNREC	21 2S 1E 1.08 A		LOT 15	OR 1480/476
3321030000190:	10016 N NATURAL WELLS DR	NATURAL WELL UNREC	21 2S 1E 1.23 A		LOT 19	OR 1328/874 2311/1945
3321030000290:	10096 N NATURAL WELLS DR	NATURAL WELL UNREC	21 2S 1E 1.34 A		LOT 29	OR 1580/2310
332103 E0350:	10052 GREEN FOUNTAIN RD	21 2S 1E	NATURAL WELLS UNIT 4		LOT 35 BLOCK E	OR 2203/1439
332103 F0040:	0 CRYSTALLINE CT	21 2S 1E	NATURAL WELLS UNIT 5		LOT 4 BLOCK F .61 A	OR 2203/1431 2227/1335
332103 F0050:	10365 CRYSTALLINE CT	21 2S 1E	NATURAL WELLS UNIT 5		LOT 5 BLOCK F .60 A	OR 2203/1431 2227/1335
3321030000100:	10049 N NATURAL WELLS DR	NATURAL WELL UNREC	21 2S 1E 1.23 A		LOT 10	OR 1605/1533
3321030000170:	2646 LOW RIDGE LN	NATURAL WELL UNREC	21 2S 1E (1.45 A)		LOT 17 LESS THE EAST PART IN EASEMT	AND .28 AC ADJACENT NORTH OF LOT
3321030000240:	10056 N NATURAL WELLS DR	NATURAL WELL UNRECORDED	21 2S 1E 1.16 A		LOT 24	OR 1140/1553
3321030000350:	2103 NATURAL WELLS DR	NATURAL WELL UNREC	21 2S 1E 2.44 A		LOTS 35 & 36	OR 1014/2270 1175/386 2049/2281



UNOFFICIAL DOCUMENT

Exhibit D

332103 E0280:	10080 GREEN FOUNTAIN RD	21 2S 1E	NATURAL WELLS UNIT 4	LOT 28 BLOCK E	OR 2069/36
332103 E0310:	0 GREEN FOUNTAIN RD	21 2S 1E	NATURAL WELLS UNIT 4	LOT 31 BLOCK E	OR 2203/1436
332103 E0360:	0 GREEN FOUNTAIN RD	21 2S 1E	NATURAL WELLS UNIT 4	LOT 36 BLOCK E	OR 2203/1436
332103 F0030:	10355 CRYSTALLINE CT	21 2S 1E	NATURAL WELLS UNIT 5	LOT 3 BLOCK F .61 A	OR 2203/1431 2227/1335
332103 F0080:	10375 CRYSTALLINE CT	21 2S 1E	NATURAL WELLS UNIT 5	LOT 8 BLOCK F .59 A	OR 2203/1431&1464 2227/1335 2341
3321030000011:	2094 NATURAL WELLS DR	NATURAL WELL UNREC	21 2S 1E .75 AC	LOT 1-B	OR 1534/1085 2078/1678
3321030000160:	10001 N NATURAL WELLS DR	NATURAL WELL UNREC	21 2S 1E 1.97 AC	LOT 16 AND ACREAGE DESCRIBED IN OR	OR 1197/2260 1225/2116
3321030000200:	10024 N NATURAL WELLS DR	NATURAL WELL UNREC	21 2S 1E 1.23 A	LOT 20	OR 1166/1163
3321030000210:	10032 N NATURAL WELLS DR	NATURAL WELL UNREC	21 2S 1E 1.19 A	LOT 21	OR 1204/1560
3321030000300:	10104 N NATURAL WELLS DR	NATURAL WELL UNREC	21 2S 1E 1.34 A	LOT 30	OR 1308/211 2060/410
3321030000310:	2110 NATURAL WELLS DR	NATURAL WELL UNREC	21 2S 1E 1.29 A	LOT 31	OR 1442/1601 2109/105 R/S
332103 E0270:	10084 GREEN FOUNTAIN RD	21 2S 1E	NATURAL WELLS UNIT 4	LOT 27 BLOCK E	OR 2203/1433 2426/776
332103 E0300:	10072 GREEN FOUNTAIN RD	21 2S 1E	NATURAL WELLS UNIT 4	LOT 30 BLOCK E	OR 2069/36
332103 E0330:	10060 GREEN FOUNTAIN RD	21 2S 1E	NATURAL WELLS UNIT 4	LOT 33 BLOCK E	OR 2203/1433
332103 E0340:	10056 GREEN FOUNTAIN RD	21 2S 1E	NATURAL WELLS UNIT 4	LOT 34 BLOCK E	OR 2203/1433 2377/164
332103 F0010:	10347 CRYSTALLINE CT	21 2S 1E	NATURAL WELLS UNIT 5	LOT 1 BLOCK F .67 A	OR 2203/1431 2227/1335
332103 F0020:	0 CRYSTALLINE CT	21 2S 1E	NATURAL WELLS UNIT 5	LOT 2 BLOCK F .64 A	OR 2203/1431 2227/1335
3321030000280:	10088 N NATURAL WELLS DR	NATURAL WELL UNREC	21 2S 1E 1.18 A	LOT 28	OR 1121/1612 2126/1010
3321030000330:	2119 NATURAL WELLS DR	NATURAL WELL UNREC	21 2S 1E 1.22 A	LOT 33	OR 1355/1497



Exhibit E

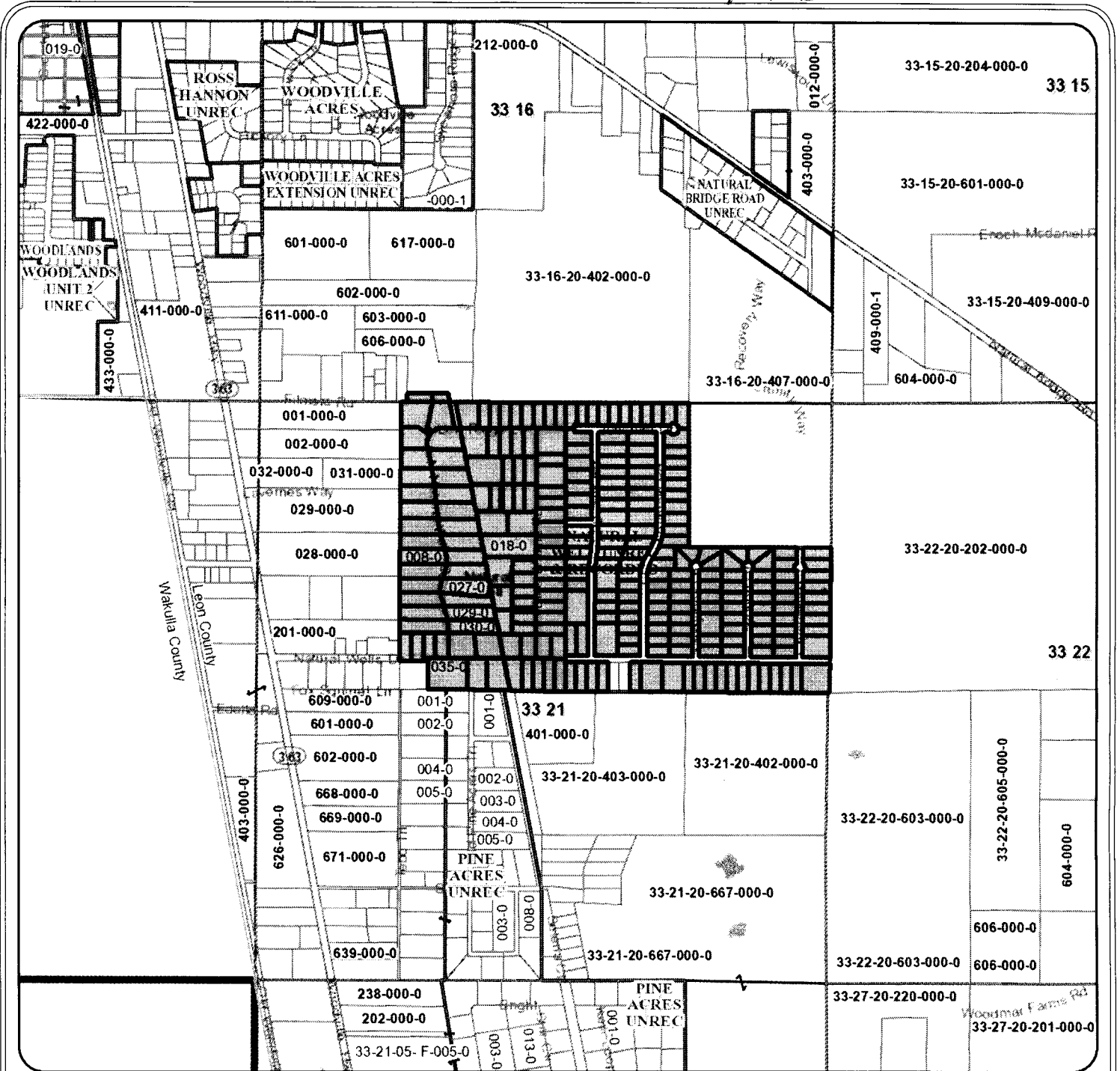

Leon County Property Appraiser

Legend

Township	Lot	Building
Section	Access Easement	Park
Subdivision	River	City Limit
Tax Parcel	Waterbody	Imagery 1/2015

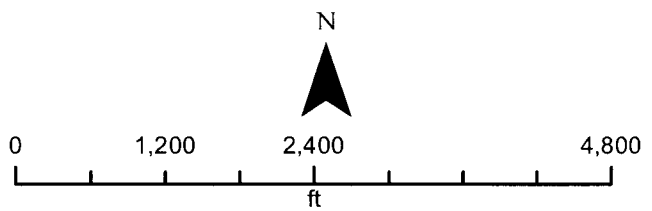

Akin Akinyemi, R.A.
Leon County Property Appraiser

315 S. Calhoun St, Third Floor
Tallahassee, FL 32301

Phone: (850) 606-6200
Fax: (850) 606-6201

Email: admin@leonpa.org
Website: leonpa.org

DISCLAIMER: This product has been compiled from the most accurate source data from Leon County, the City of Tallahassee, and the Leon County Property Appraiser's Office. However, this product is for reference purposes only and is not to be construed as a legal document or survey instrument. Any reliance on the information contained herein is at the user's own risk. Leon County, the City of Tallahassee, and the Leon County Property Appraiser's Office assume no responsibility for any use of the information contained herein or any loss resulting therefrom.

Date Drawn: Jul 02, 2017

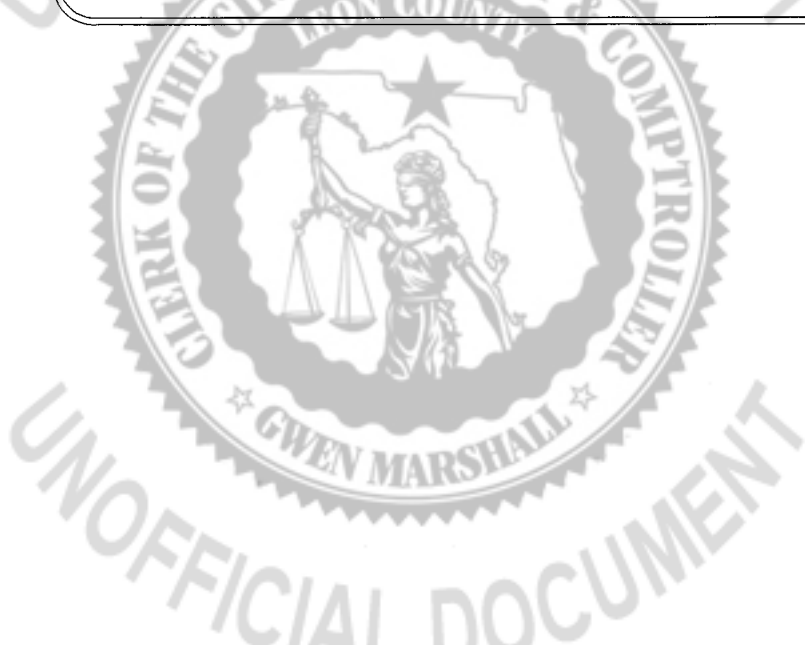

7/2/2017

Leon County Property Appraiser

Exhibit E

Intersection e.g. park & duval

enter a parcel id

Selection

Selected: [258] Available: [258]

- 332103 A0010
- 332103 A0020
- 332103 A0030
- 332103 A0040
- 332103 A0050
- 332103 A0060
- 332103 A0070
- 332103 A0080
- 332103 A0090
- 332103 A0120

View Current List
Return to Search

Reports

- Mailing List
- Property Data Export

Go

TLGGIS | LCPA, TLGGIS

UNOFFICIAL DOCUMENT

<http://www.leonpa.org/pt/Maps/MapAdv.aspx?slIndex=3&SearchMode=advanced&subjectPin=&fullmap=true>



UNOFFICIAL DOCUMENT

PREPARED BY:
JOHN L. BISCHOF, ESQUIRE
c/o Post Office Box 3621
Tallahassee, FL 32315

RE: NATURAL WELLS HOMEOWNER ASSOCIATION, INC

AFFIDAVIT FOR FILING THE
NOTICE OF PRESERVATION OF COVENANTS AND RESTRICTIONS
UNDER MARKETABLE RECORD TITLE AC

I, Hector DeLaO, am an individual over 18 years old with personal k knowledge of all facts declared in this Affidavit.

I am on the Board of Directors of Natural Wells Homeowner Association, Inc, a Florida not-for-profit corporation (Association)

I affirm that the Notice of Meeting and Statement of Marketable Title Action for Natural Wells Home Owners Association, Attached as Exhibit 1 to this Affidavit was mailed on or about April 17, 2017 to each member of the Association whose property is governed by the Declaration of Covenants, Conditions and Restrictions recorded as follows

- June 8, 1984 - Book 1117, Page 1261
- February 25, 1986 - Book 1196, Page 1351
- February 10, 1987 - Book 1247, Page 0930;
- March 14, 1990 - Book 1423, Page 0491
- January 31, 1992 - Book 1541, Page 0388
- November 14, 1995 - Book 1856, Page 2204

of the public records of Leon County, Florida.

The notice was sent to each member at least 7 days before the meeting of the Board of Directors on April 26, 2017.

Under penalties of perjury, I declare that I have read the foregoing affidavit and the facts stated in it are true.

DATED: 7-6-17

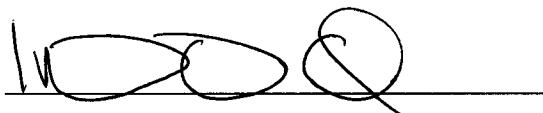

Hector DeLaO, Board President

Leon County, State of Florida

The foregoing instrument was sworn to and acknowledged before me on July 6, 2017 by Hector DeLaO, who ___ is personally known to me or ___ has produced a driver's license as identification and who did take an oath that the foregoing is true to the best of her knowledge.

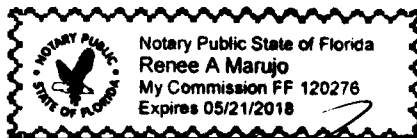

Notary Public:

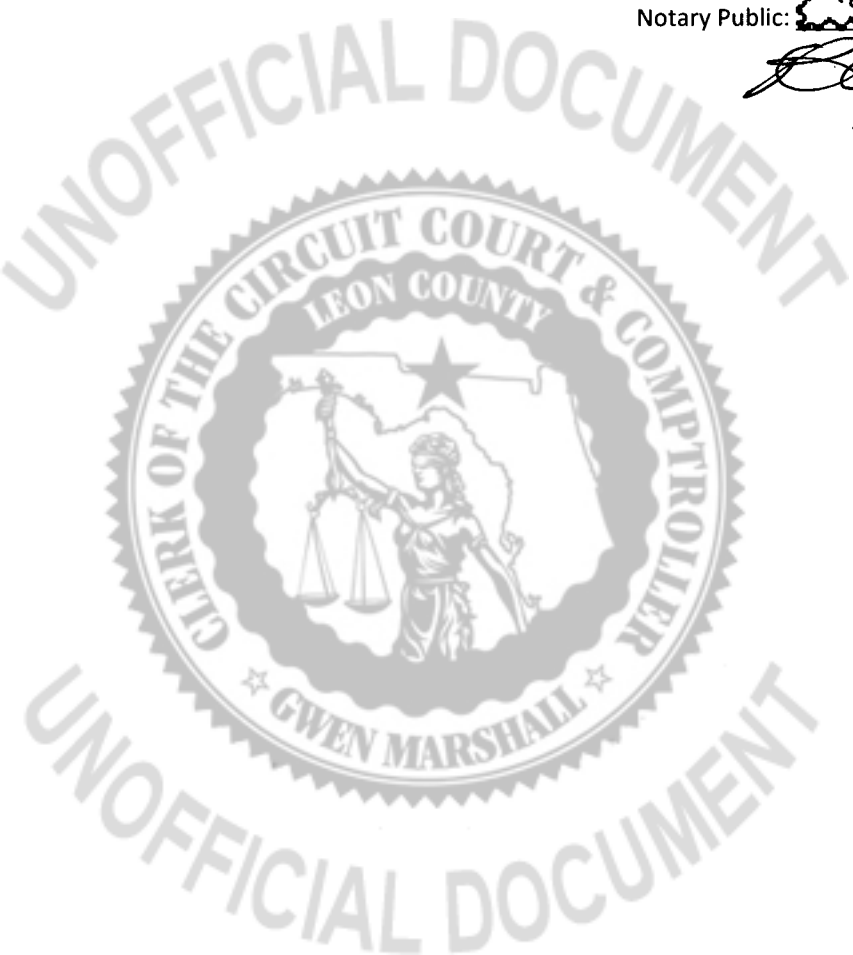
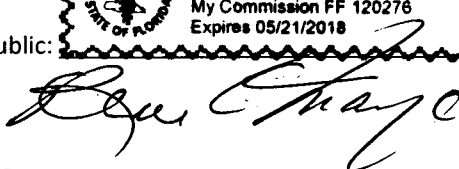

NATURAL WELLS HOMEOWNERS ASSOCIATION
MEETING NOTICE TO BE ADDED TO BOARD OF DIRECTORS MEETING
APRIL 26, 2017 6:00 PM - WOODVILLE LIBRARY
NOTICE OF INTENT TO RENEW COVENANTS

Notice that the Board of Directors, Natural Wells Homeowner Association, Inc., will hold a Board meeting after the Annual Meeting on April 26, 2017 at 6:00 p.m. at the Woodville Library.

The Board of Directors will take a special vote to preserve the Associations' Declaration of Covenants, Conditions and Restrictions of Natural Wells Homeowner Association recorded in the Public Records of Leon County at:

- June 8 1984 - Book 1117, Page 1261
- February 25, 1986 - Book 1196, Page 1351
- February 10, 1987 - Book 1247, Page 0930;
- March 14, 1990 - Book 1423, Page 0491
- January 31, 1992 - Book 1541, Page 0388
- November 14, 1995 - Book 1856, Page 2204

This action will protect the Covenants from extinguishment under Florida's Marketable Record Title Act (MRTA), Chapter 712 of the Florida Statutes. This action will preserve the covenants for 20 years. This vote is required to preserve the covenants at this time to protect the integrity of the neighborhood and every owner's property value. The covenants can be preserved for an additional 30 years by a 2/3 vote of the Board on April 26, 2017.

The mailing address for the Association is: Natural Wells Homeowners Association, Post Office Box 3621, Tallahassee, FL 32315. A copy of this notice is being mailed to all members of the association.

STATEMENT OF MARKETABLE TITLE ACTION

The Natural Wells Homeowners Association (the "Association") has taken action to ensure that the Declaration of Covenants, Conditions and Restrictions of Natural Wells, recorded in Official Records as noted above of the public records of Leon County, Florida, as may be amended from time to time, currently burdening the property of each and every member of the Association, retains its status as the source of marketable title with regard to the transfer of a member's residence. To this end, the Association shall cause the notice required by Chapter 712, Florida Statutes, to be recorded in the public records of County, Florida. Copies of this notice and its attachments are available through the Association pursuant to the Association's governing documents regarding official records of the Association.

For additional information please contact the Association's management Company at: Assoc_mgt@yahoo.com ; Post Office Box 3621, Tallahassee, FL 32315 ; (850) 528-5043.

I hereby certify that a copy of this Notice was mailed to all members of the Association on April 17, 2017

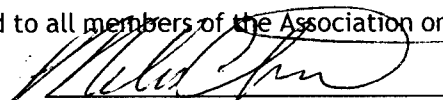
Melisa Smith, CAM

